

AURORA[®] AFX[®] WORLD CHAMPIONSHIP and STOCK ROD RACING GENERAL INSTRUCTIONS

DETAILED TRACK ASSEMBLY INSTRUCTIONS

1

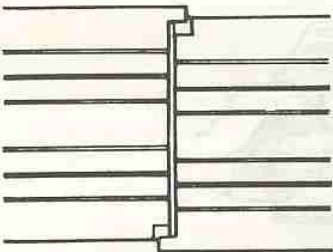

SPEED-LOK TRACK

So easy - to - assemble! Simply position two track sections as shown, with end tabs partially hooked. Track is now ready to snap together.

2

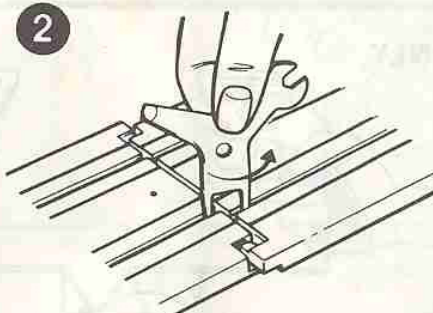

TO ASSEMBLE

Holding the Quikee-Lok Key firmly, insert it straight into the track slots. Twist firmly in the direction indicated (counter-clockwise) until the track snaps into place.

3

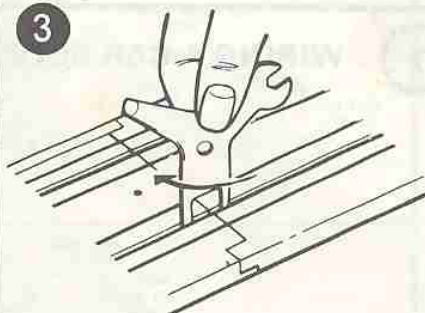

TO OPEN TRACK

Holding track with one hand, insert the Quikee-Lok Key into the track slots. Twist firmly in the direction shown (clockwise) and the track will snap open.

4

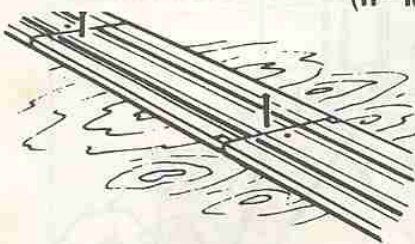

After you have assembled your set, place it on a piece of 1/2" plywood. At the end of each piece of track there is a small hole designed for a 18 gauge wire brad (not included). Place the brads into the holes as shown.

TRACK MOUNTING

(IF MAXIMUM PERFORMANCE IS DESIRED)

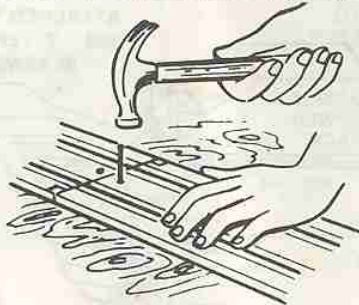

Using a small hammer carefully nail the track into place. Do not hit the brad too hard. If the hammer slips you may damage the track.

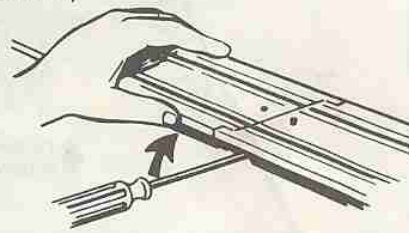

If you wish to add onto or change your track layout, you may lift the track by placing a screw driver under the edge of track as shown and slowly prying it up.

5

Before racing your cars wipe down your track layout with a clean lint-free cloth.

Note: Do not use Polishes or Solvents to clean track.

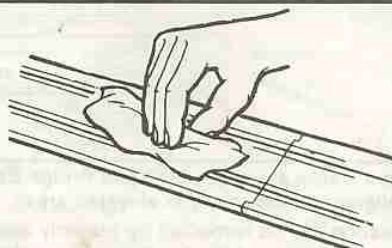

IMPORTANT NOTE: Your cars may hesitate at first. This is due to a protective coating on the rails which will normally wear off after your cars travel around the layout a few laps.

6 TRACK REPAIR CLIPS

(used if locking tabs break off)

Several Track Clips have been included in a separate poly-bag with your set. They are not required to assemble your layout. However, should the Locking Tabs on a track section break off for any reason, the track sections can be held together using the clips as shown in the drawings.



Track Clip

For all Banked Curve Track

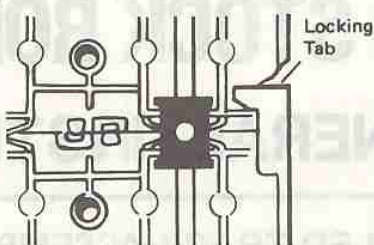

For Regular Track

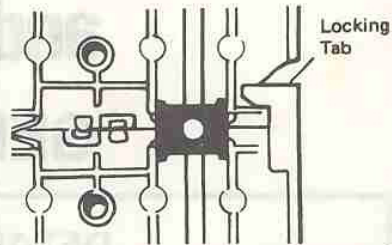

7 WIRING 4-CAR SETS ONLY

Wire up your controllers to the CLIP ON Terminals as shown in illustration at right. Use the screw driver end of your QUIKEE-LOK KEY to insert the Terminal Screws.

NOTE: Terminal Screws are supplied in a separate parts bag.

NOTE: Every controller has a protective coating on the internal resistors to prevent rust. This may burn off and smoke slightly when controllers are activated.

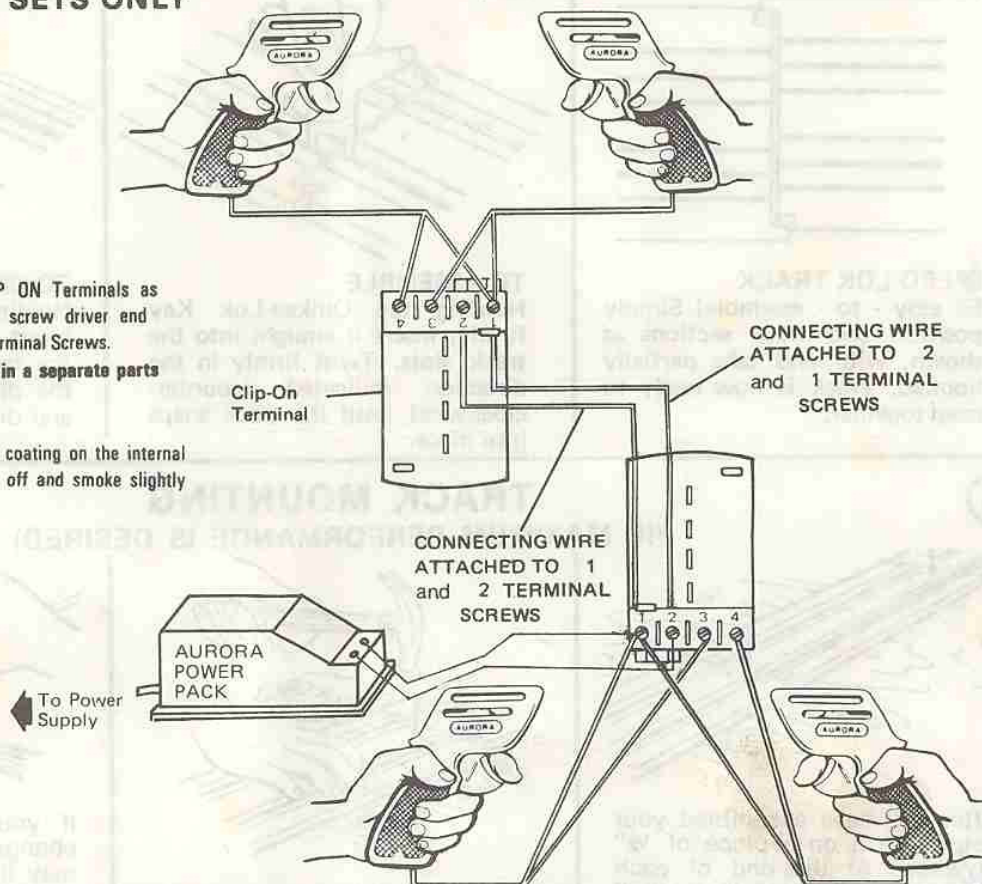

8 HOW TO CHECK TRACK ALIGNMENT ON 4-CAR LAYOUTS ONLY

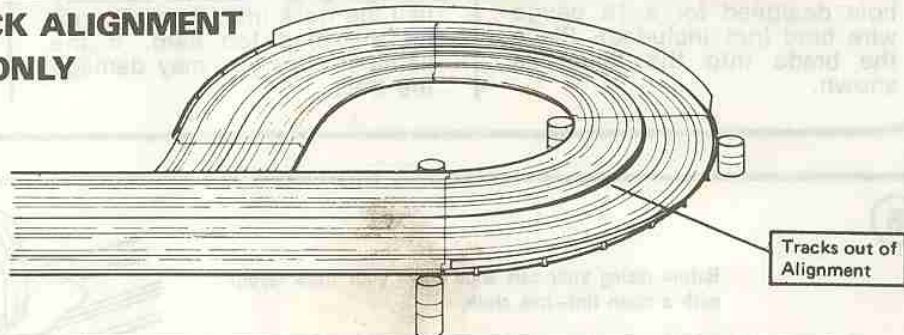

- After your tracks are assembled and Bridge Beams are in position under tracks, you may find some track surfaces out of alignment, especially in elevated areas.
- This situation can be remedied by properly seating the tracks on the Bridge Beams until track surfaces are level.
- Slight re-positioning of Bridge Beams may also help alleviate this problem.

TROUBLE SHOOTING CHART

Refer to the Trouble Shooting Chart below for your particular problem.
Then look for the diagram or diagrams shown below for the best solution.

PROBLEM	A	B	C	D	E	F	G	H	I	J
	LUBRI- CATION	INCORRECT WIRING	RAIL TABS DO NOT TOUCH	DIRTY TRACKS	CARS DIRTY	WHEEL BODY INTERFER.	DIRTY OR WORN PICK-UP SHOES	MORE THAN ONE CAR IN LANE	DIRTY TIRES	EXCESSIVE OILING
CARS WON'T RUN		●	●			●				●
CARS HESITATE				●	●		●			
CARS RUN NOISY	●				●	●				
CARS RUN SLOWLY OR OVERHEAT	●				●	●	●	●		●
CAR SPIN OUTS				●					●	
CONTROLLERS HOT or SMOKE								●		
SOUND UNITS (OPTIONAL IN SOME SETS)		● (SEE INSTRUCTIONS)								

A

OIL SPARINGLY! A LITTLE GOES A LONG WAY!

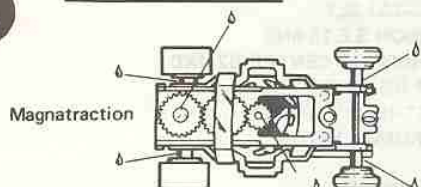

Magnatraxion

Magnatraxion
Specialty
Chassis

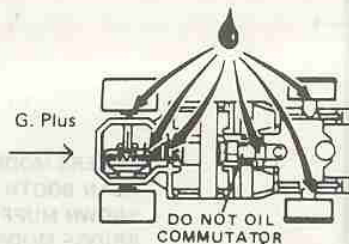
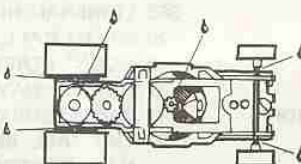

G. Plus

DO NOT OIL
COMMUTATOR

NOTE: MAGNATRAXION & MAGNATRAXION SPECIALTY CHASSIS.
Apply oil to armature bearing hole from underside. See illustration J. Fig. 1.

B

RECHECK 2 CAR SET WIRING

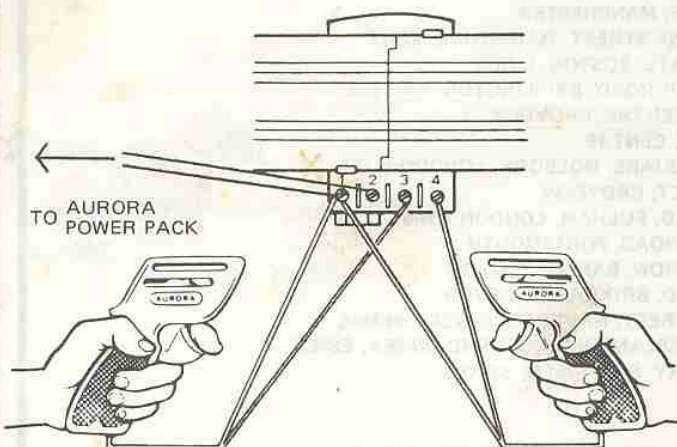

Wire to Terminals
No. 1 and No. 3

Wire to Terminals
No. 1 and No. 4

RECHECK 4 CAR SET WIRING

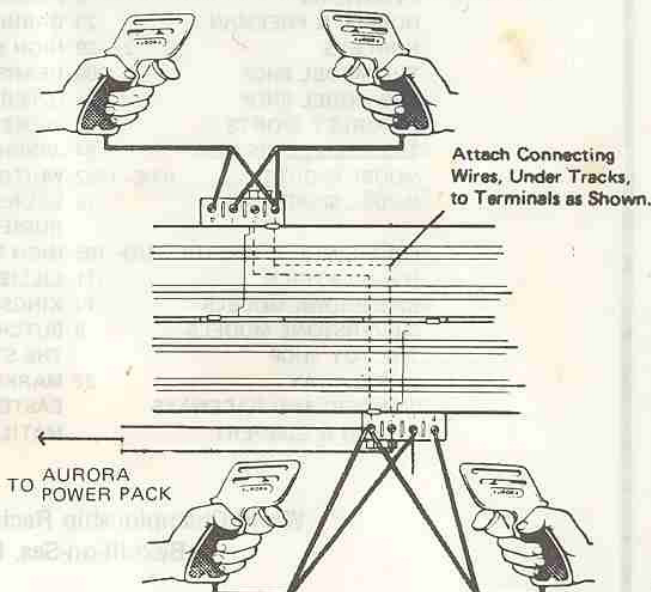

Attach Connecting
Wires, Under Tracks,
to Terminals as Shown.

C CHECK TRACK POWER

Check for track power by squeezing trigger on your controllers and placing the **PICK-UP-SHOES** of a car, on the rails of both lanes on all track sections.

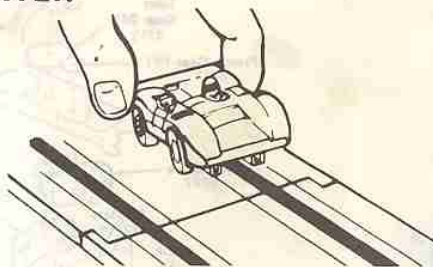

RAIL TABS MUST TOUCH

If the wheels of the car do not spin on a particular track section, separate tracks with Quik-Lok Key and rebend **RAIL TABS** to angle shown before reassembling.

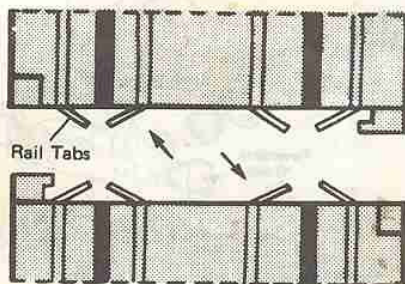

D CLEAN TRACK

A Wipe down your tracks with clean cloth to remove lint and dust.

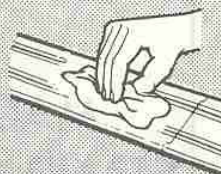

B A carborundum eraser can be used to clean Metal Rails on track Surface as shown.



E REMOVE LINT FROM AXLES

When racing your cars over long periods, lint and dust may accumulate around the axles. Remove with a toothpick or small tweezers, as shown.

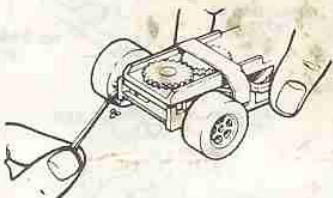

F REALIGN CHASSIS

After a crash, the snap-on body of your car may shift and cause tyre-body interference. This can be corrected by holding the car upside-down and centralising the chassis until it snaps back into position.

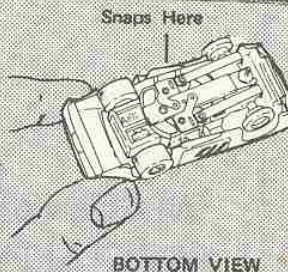

BOTTOM VIEW

G

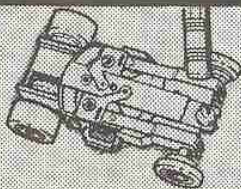

The pick up shoes on your cars should be cleaned regularly by rubbing them with a carborundum eraser as shown. Do not use a standard pencil eraser. The pick up shoes should sit flat on the track rails when viewed from the front and side. When the shoes become grooved with wear they should be replaced.

H

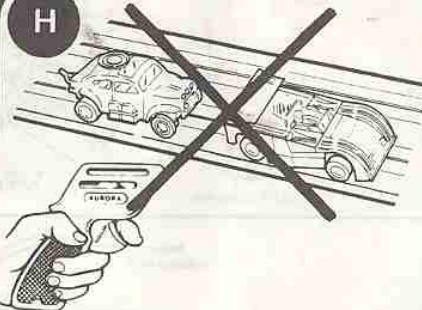

Do Not race more than one car at a time in one lane. It will cause your Controller to get hot and possibly burn out.

I

CLEAN REAR TYRES

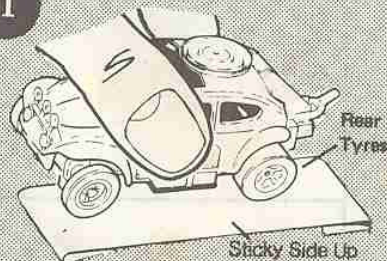

One very effective way to clean tyres is to place a piece of tape on a table as shown and roll rear tyres on it a few times.

J

CLEAN OFF EXCESSIVE OIL

Great care should be taken not to over oil your cars, especially at the bottom armature bearing hole.

If this happens use a cotton-tipped swab, saturated with rubbing alcohol to clean the chassis completely. See Figure 1.

Using a pencil eraser carefully clean the Commutator. New Motor Brushes should now be installed, car reassembled and carefully oiled. See Figure 2.

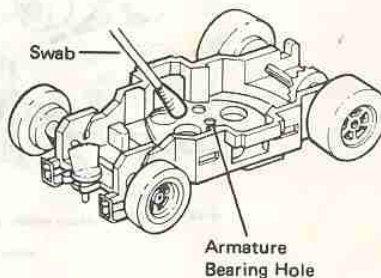

Fig. 1

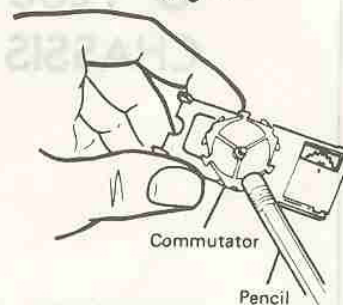

Fig. 2

For Accessories, Servicing and Spare Parts

WHEN YOU REQUIRE EXTRA CARS AND TRACK, OR
IF YOUR AURORA RACING CAR, OR ANY OTHER
PART OF YOUR SET REQUIRES SERVICING, PLEASE
TAKE, OR SEND IT TO THE AURORA "PIT STOP CENTRE"
NEAREST TO YOUR HOME

Aurora A.F.X. Motor Racing Dealers and Pit Stop Centres

BEATTIES OF LONDON LTD.	10 THE BROADWAY, SOUTHGATE N14 6PN
	112 HIGH HOLBORN, LONDON WC1V 6JS
	14 SPRING GARDENS, MANCHESTER M2 1EE
	18 KING CHARLES STREET, LEEDS LS1 6LT
	363 LEWISHAM HIGH STREET, LONDON S.E.13 6NZ
	26 SOUTH MALL, BIRMINGHAM SHOPPING CENTRE B2 4XD
	3 MOUNT STREET, NOTTINGHAM NG1 6JW
	36/37 DAWSON WAY, ST. JOHN'S CENTRE, LIVERPOOL
	14 CANTERBURY STREET, GILLINGHAM, KENT
BAKERS MODEL SHOP	21 THE MALL, BURY, LANCs
ALAN BOOTH	MARKET STREET, BRADFORD, YORKs
BROWN MUFF LTD.	1-2 STATION PARADE, LONDON E.17
BRIDGE MODELS	BRIDGE STREET, BRADFORD, YORKs
CARTERS	4 HIGHER EYNAM, BLACKBURN, LANCs
B. E. CLAYTON	WELL HALL ROAD, ELTHAM, LONDON S.E.9
ELTHAM MODELS	5 ALEXANDRA ROAD, GRIMSBY, LINCs
EVINGTONS	23 GABRIELS HILL, MAIDSTONE, KENT
HUBBLE & FREEMAN	27-29 HIGH STREET, BURNHAM-ON-SEA, SOMERSET
HURLEYS	209 DEANSGATE, MANCHESTER
THE MODEL SHOP	UPPER STONE STREET, MAIDSTONE, KENT
THE MODEL SHOP	5-7 WIDEBARGATE, BOSTON, LINCs
J. MORLEY SPORTS	84 WINCHESTER ROAD, BRISLINGTON, BRISTOL
THE MODELLERS DEN	1086-1087 WHITGIFT CENTRE, CROYDON
MODEL SPORTS	18 BRUNSWICK CENTRE
MODEL SPORTS	RUSSELL SQUARE, HOLBORN, LONDON W.C.1
PRIORS MODEL SPORTS	103-105 HIGH STREET, CROYDON
D & H PATRICK	111 LILLIE ROAD, FULHAM, LONDON S.W.6
RAY BROWN MODELS	10 KINGSDON ROAD, PORTSMOUTH
SILVERSTONE MODELS	9 BUTCHERS ROW, BANBURY, OXON
THE TOY SHOP	THE STRAND, BRIXHAM, S. DEVON
WHEELAWAY	22 MARKET STREET, HAVERFORD WEST, PEMS.
WONDERLAND RACEWAYS	EASTERN ESPLANADE, SOUTHEND-ON-SEA, ESSEX
WILSON & GUMPERT	MATILDAWAY, SHEFFIELD, YORKs

*New Oxford at
Southampton
Lings Russell Show*

World Championship Racing Headquarters, P.O. Box No. 4
Bexhill-on-Sea, East Sussex TN39 3LL

MAGNATRACTION® STANDARD (STD) CHASSIS

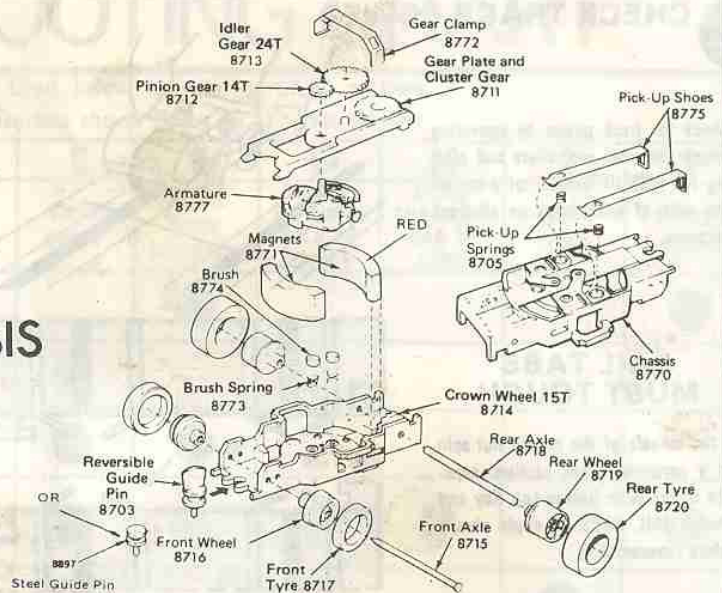

MAGNATRACTION® SPECIALTY CHASSIS (IDENTIFIED BY 2 SCREWS IN UNDERSIDE OF CHASSIS)

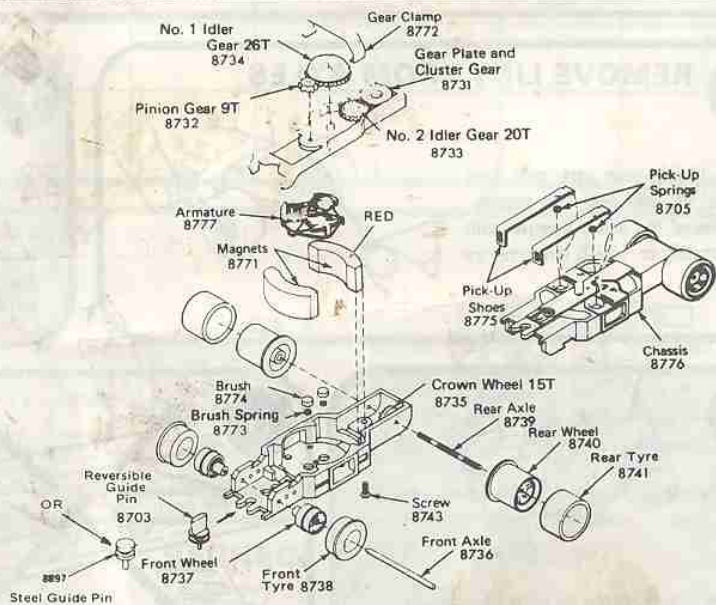

G-PLUS® CHASSIS

